

Note:  
The location of  
the green route is  
confirmed by a  
series of culverts.

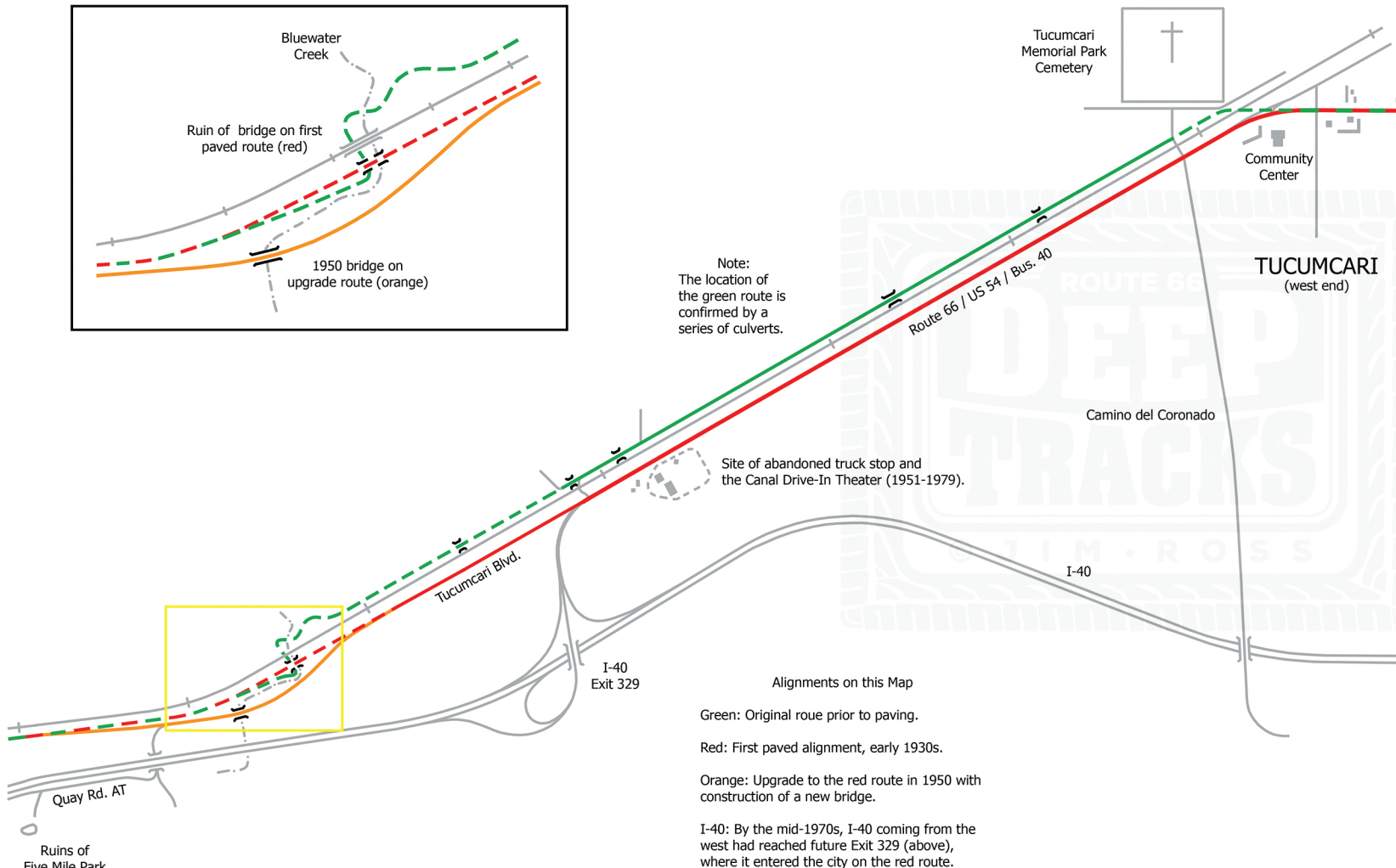

Alignments on this Map

Green: Original route prior to paving.

Red: First paved alignment, early 1930s.

Orange: Upgrade to the red route in 1950 with construction of a new bridge.

I-40: By the mid-1970s, I-40 coming from the west had reached future Exit 329 (above), where it entered the city on the red route. Tucumcari was not bypassed by the interstate until 1981.