

Between Lupton (east)
and Holbrook (west)

Alignments on this Map

Green: Original route prior to paving.

Red: First paved alignment, circa 1931.

Orange: 1950s 2-lane upgrade to the red route, later adopted by westbound I-40.

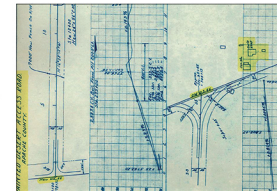
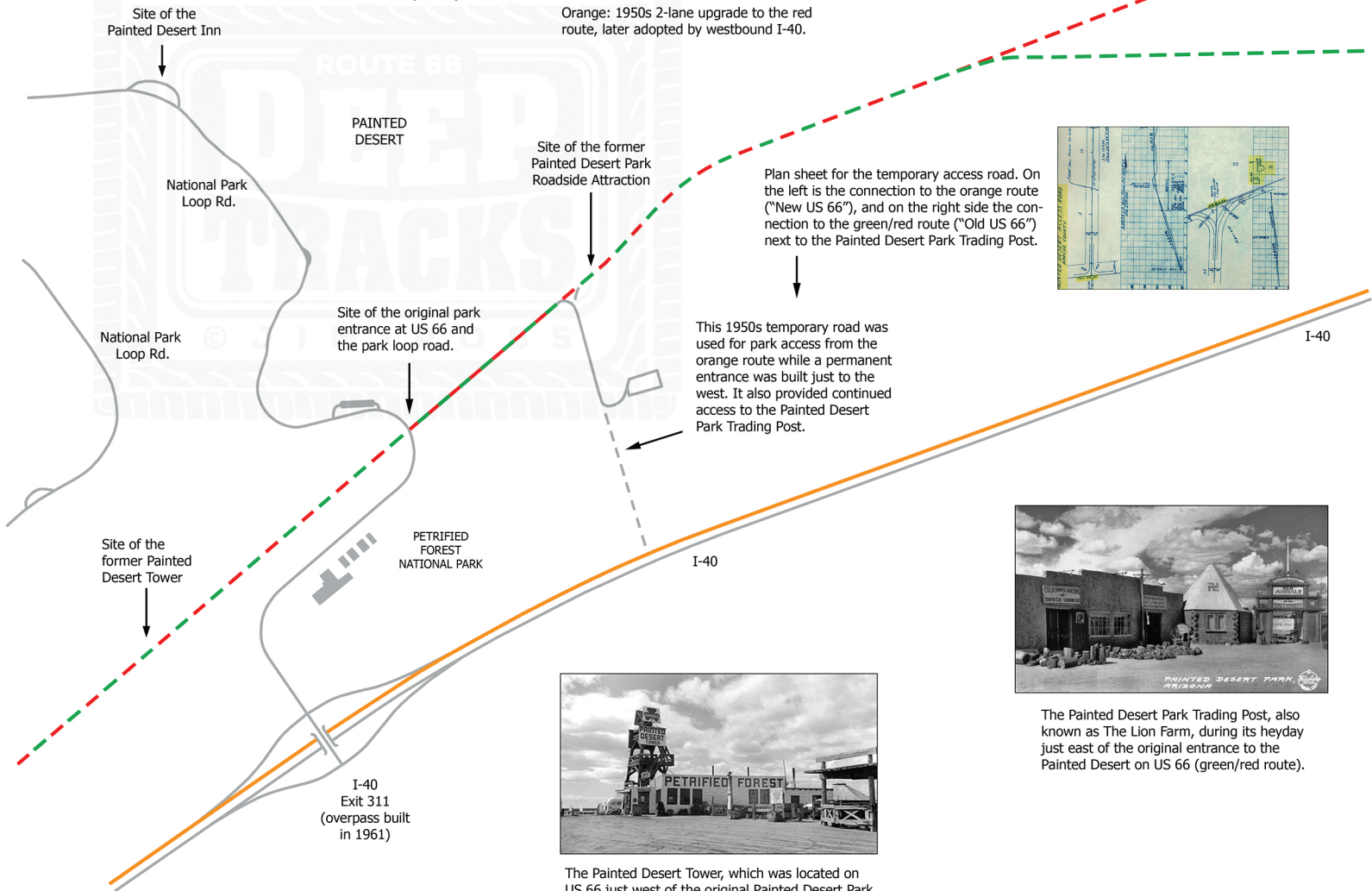

Plan sheet for the temporary access road. On the left is the connection to the orange route ("New US 66"), and on the right side the connection to the green/red route ("Old US 66") next to the Painted Desert Park Trading Post.

This 1950s temporary road was used for park access from the orange route while a permanent entrance was built just to the west. It also provided continued access to the Painted Desert Park Trading Post.



The Painted Desert Park Trading Post, also known as The Lion Farm, during its heyday just east of the original entrance to the Painted Desert on US 66 (green/red route).



The Painted Desert Tower, which was located on US 66 just west of the original Painted Desert Park entrance (green/red route).