

Alignments on this Map

Green: Original route prior to paving, following the path of the former National Old Trails Road.

Red: First paved alignment (1930s), excavated when the orange upgrade 2-lane was built in the early 1950s. Part of red route's pathway was later used by westbound I-40.

Orange: Early 1950s upgrade to the red route, which was later adopted by eastbound I-40.

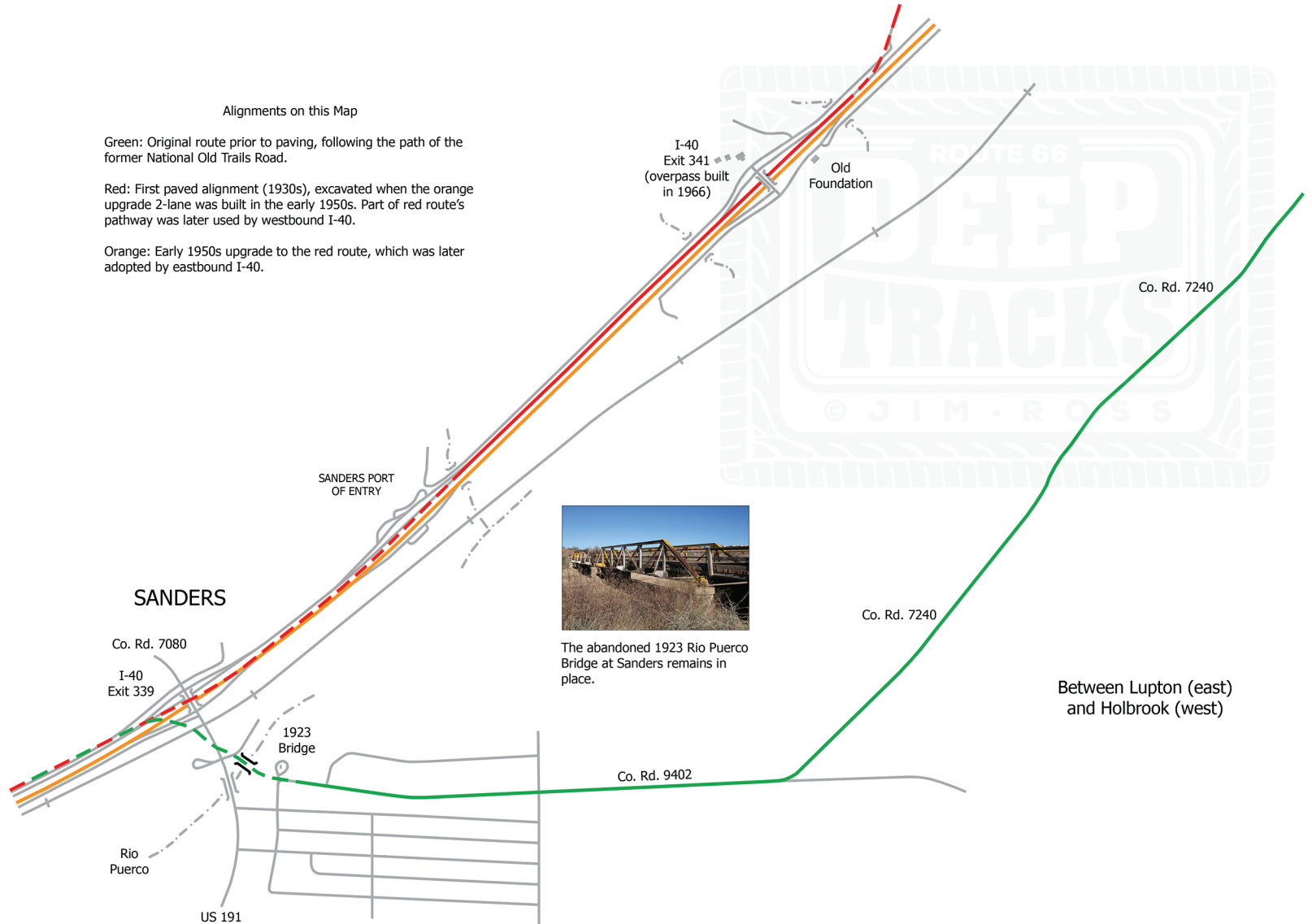

The abandoned 1923 Rio Puerco Bridge at Sanders remains in place.

Between Lupton (east)  
and Holbrook (west)