

Between Arcadia (east)
and Bethany (west)

Note on Alignments:

The green/red route, paved in brick in the mid-1920s, passed through Edmond on 2nd St. (previous map) and Broadway, curving onto Kelley Ave. (bottom of map).

In 1953-1954, when US 66 and US 77 were moved to the orange route (Maps 62-66), the route through Edmond was designated OK 66 and OK 77. In 1962, those routes shifted from Kelley Ave. onto the Broadway Extension to Oklahoma City (gray, bottom of map).

In 1965, the designations for OK 66 and OK 77 were removed. At that time, US 66 continued as the orange route, while US 77 returned to 2nd St. and Broadway through Edmond and onto the Broadway Extension to Oklahoma City, turning east to Lincoln Blvd. at the junction with the 4-lane route (Map 67). US 77 on Lincoln was moved back to the Broadway Extension once it was completed into downtown Oklahoma City.

OKLAHOMA CITY

EDMOND

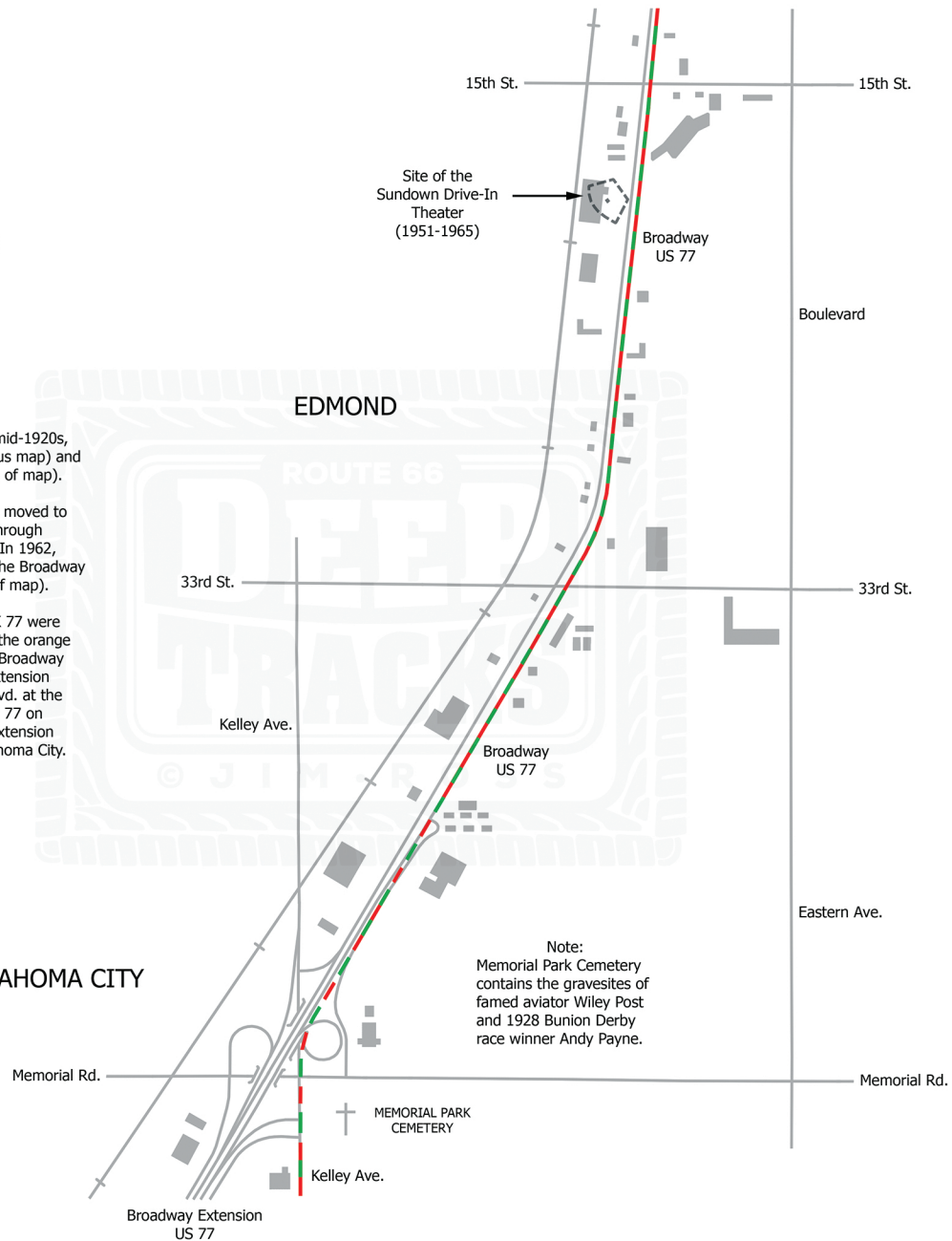

Site of the
Sundown Drive-In
Theater
(1951-1965)

Broadway
US 77

Boulevard

33rd St.

33rd St.

Kelley Ave.

Broadway
US 77

Eastern Ave.

Memorial Rd.

Memorial Rd.

MEMORIAL PARK
CEMETERY

Kelley Ave.

Broadway Extension
US 77

Note:
Memorial Park Cemetery
contains the gravesites of
famed aviator Wiley Post
and 1928 Bunion Derby
race winner Andy Payne.