

Alignments on this Map

Green: Original route prior to paving.

Red: First paved alignment (1930s), which removed some of the curves from the green route.

Orange: Early 1950s upgrade to the red route, which followed the path of eastbound I-40 until transitioning to the path of westbound I-40 at today's Exit 333.

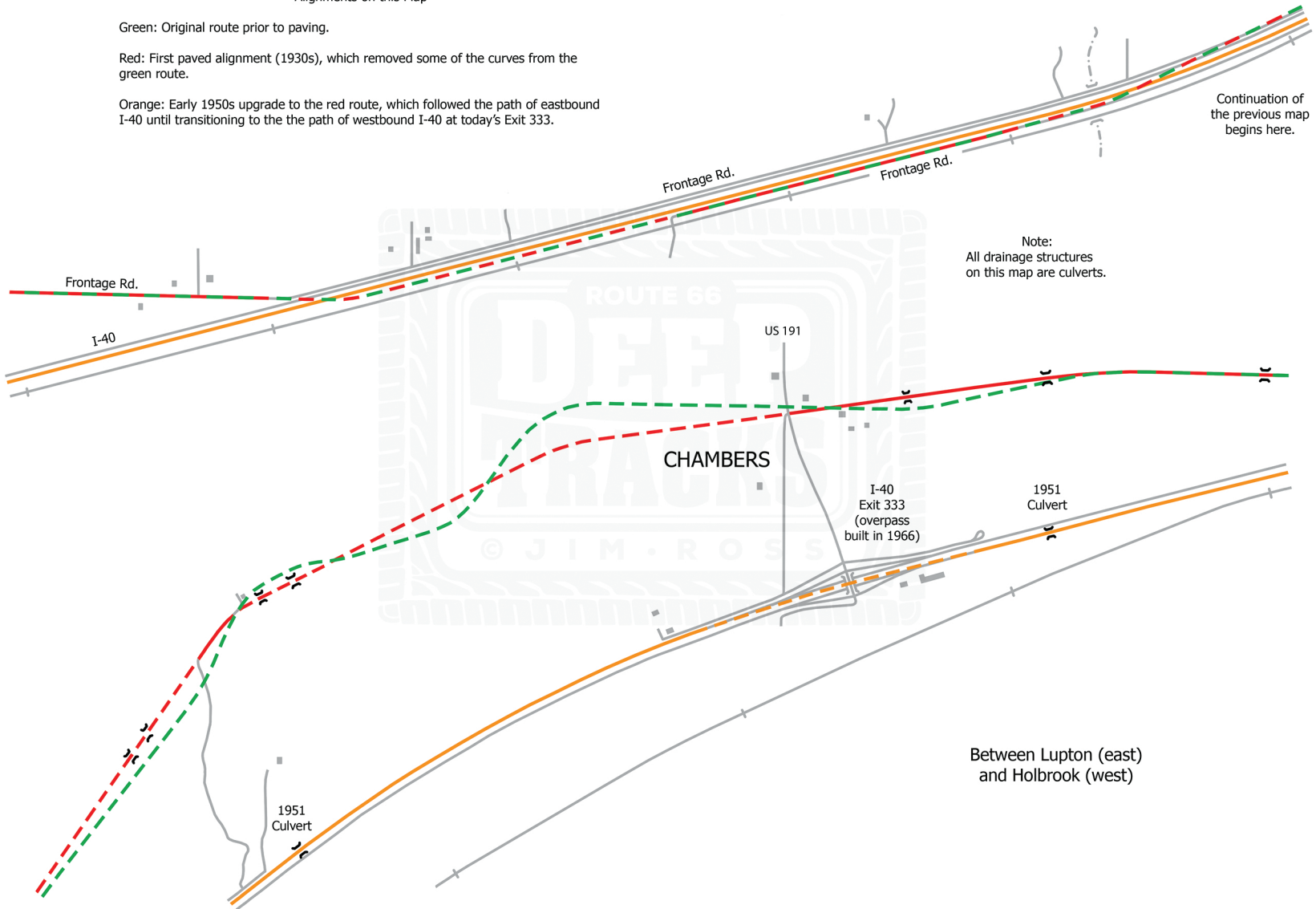

Continuation of the previous map begins here.

Note:  
All drainage structures on this map are culverts.

Between Lupton (east) and Holbrook (west)